

THIS DRAWING IS UNPUBLISHED. RELEASED FOR PUBLICATION  
 © COPYRIGHT - TE Connectivity ALL RIGHTS RESERVED.

REVISIONS					
P	LR	DESCRIPTION	DATE	OWN	APP
F1		REV. ECO 17-011267	11SEP2017	HC	KR

- MUST BE ASSEMBLED WITH CAP REAR P/N 770046-1 BEFORE MATING. KIT P/N IS 770024-1.
- RECOMMENDED PANEL THICKNESS 0.76-2.29 [.030-.090].
- PANEL MUST BE PUNCHED SO THAT THE HOUSING ENTERS THE PANEL IN THE SAME DIRECTION AS THE PUNCH.
- OPTIONAL FOR KEYING HOUSING IN PANEL.
- CIRCUIT NUMBER 1 LOCATION.
- AMP LOGO LOCATED ONCE ON ANY INDICATED SURFACE FAR SIDE.
- DIMENSION INDICATED IS AS MOLDED. ADDITIONAL GROWTH DUE TO SUBSEQUENT MOISTURE ABSORPTION MAY OCCUR.
- CSA LOGO LOCATED ONCE ON ANY INDICATED SURFACE

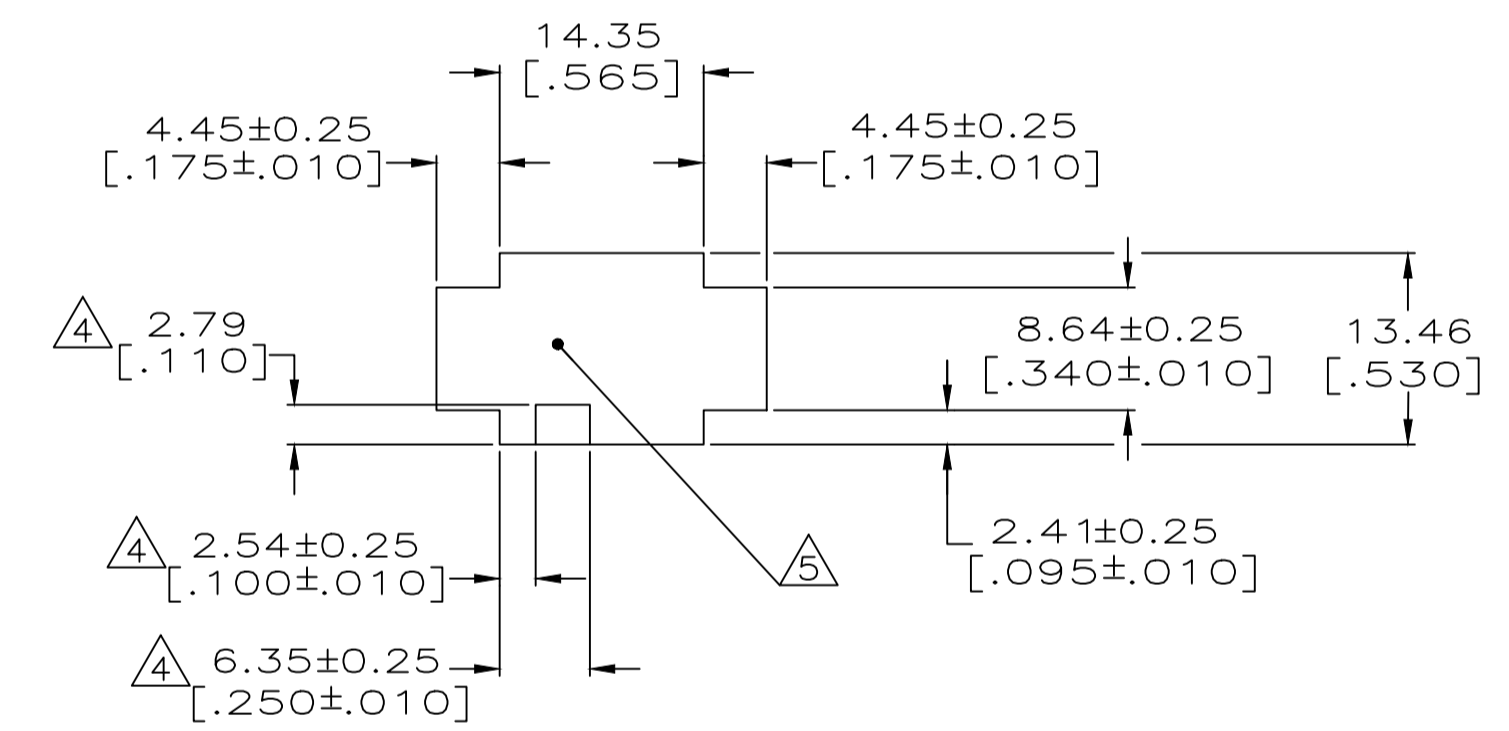
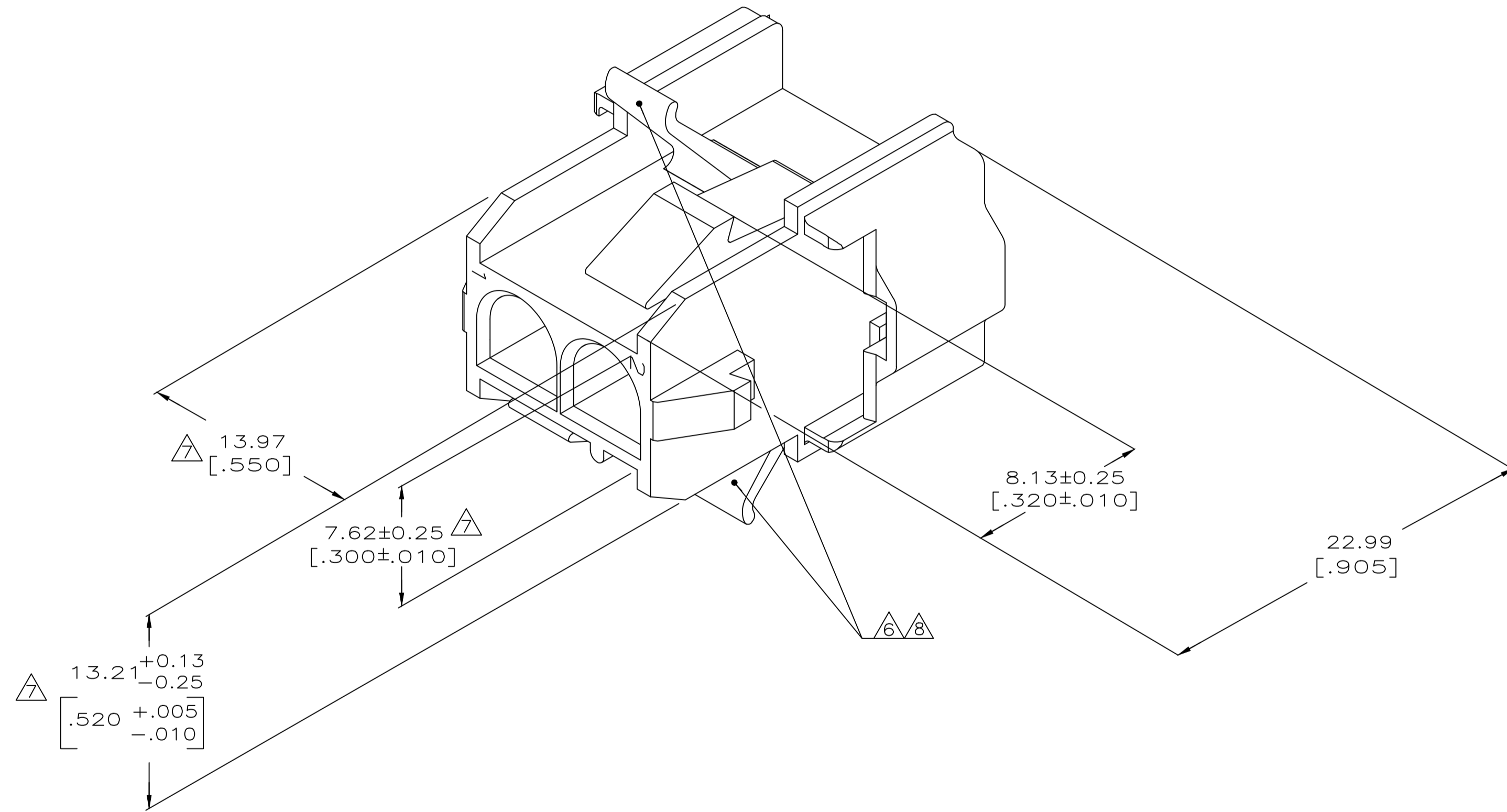

RECOMMENDED PANEL CUTOUT  
 (HOUSING ENTRY SIDE)  
 SCALE 2:1

770045-1  
 PART NUMBER

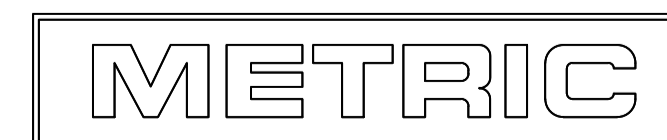

THIS DRAWING IS A CONTROLLED DOCUMENT.		DWN K. SALMON 1-15-92	TE Connectivity	
DIMENSIONS: INCHES		CHK R. SWING 1-15-92	CAP FRONT, 2 CIRCUIT, UNIVERSAL MATE-N-LOK™ II	
TOLERANCES UNLESS OTHERWISE SPECIFIED:		APPD M. TRULL 1-16-92	RESTRICTED TO	
0 PLC ± -	1 PLC ± -	NAME	SIZE	CAGE CODE
2 PLC ± -	3 PLC ± 0.13 [.005]	APPLICATION SPEC	A1	00779
4 PLC ± -	ANGLES ± -	WEIGHT	SCALE	DRAWING NO
MATERIAL NYLON,UL94V-0,	FINISH	1	5:1	C=770045
CUSTOMER DRAWING		SHEET	1	OF
		REV	F1	